

FOR LEASE - RETAIL

Forest Hills Plaza

5313 - 17 Avenue SE
Calgary, AB



FOR LEASE
MANY
OPPORTUNITIES EXIST
4,830 and 8,800 SQ. FT.



Highlights

- 50% of population between 25 - 54
- Easy access to 17th Avenue SE.
- Pylon signage available.
- Major thoroughfare to Chestermere.
- Ideal for food service.

FOR FURTHER INFORMATION, PLEASE CONTACT:

Blair Mastin
bmastin@naicalgary.com
Direct: (403) 291-8869

Colleayn Mastin
cmastin@naicalgary.com
Direct: (403) 291-8868

NAI Commercial

Commercial Real Estate Services, Worldwide.

Suite 1, 6204 - 6A Street SE
Calgary, AB T2H 2B7
Tel: (403) 214-2344
Fax: (403) 214-0244
www.naicalgary.com

FOR LEASE Forest Hills Plaza

5313 - 17 Avenue SE
Calgary, AB

Location Maps



Property Description

Leasable Area:	4,830 sq. ft. and 8,800 sq. ft.
Available:	Immediately
Net Rate:	Market
Op. Costs:	\$7.69 p.s.f.
Anchor:	Marks Work Warehouse

Floor plan

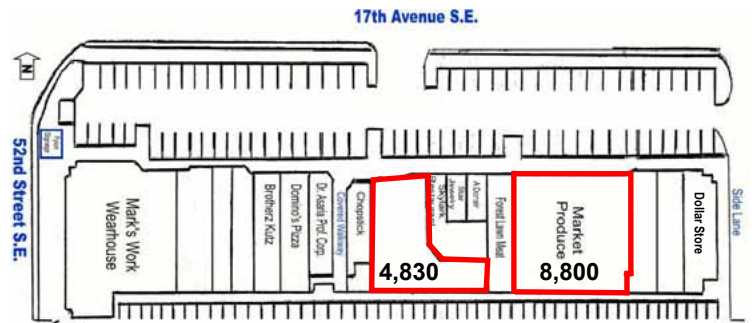

NAI Commercial

Commercial Real Estate Services, Worldwide.

The information contained herein has been given to us by the owner of the property or other sources we deem reliable. We have no reason to doubt its accuracy, but we do not guarantee it. All information should be verified by Purchaser prior to purchase.

FOR FURTHER INFORMATION, PLEASE CONTACT:

Blair Mastin
bmastin@naicalgary.com
Direct: (403) 291-8869

Suite 1, 6204 - 6A Street SE
Calgary, AB T2H 2B7
Tel: (403) 214-2344
Fax: (403) 214-0244
www.naicalgary.com

Colleayn Mastin
cmastin@naicalgary.com
Direct: (403) 291-8868